

VISIONSCAPE® 智能相机

机器视觉处理系统



Visionscape 系列智能相机体积小、应用范围广、功能多样且具备性能成熟的 Visionscape 软件。Visionscape 可用于多种应用场合，能为制造商提供符合成本效益且易于部署的解决方案，以监控质量、控制流程或识别及跟踪生产线上的部件。

高度灵活的配置

Visionscape 相机配备 C-Mount 接口光学设备和独立的照明系统，含内置数码输入 / 输出、串行通讯和以太网连接功能。所有处理工作均使用高性能嵌入式 CPU 完成。

耐用设计

Visionscape 采用铸造合金 IP67 封装和 M12 连接器，是要求较高的工业应用环境的理想选择。

应用举例

- 装配验证 (汽车、医疗设备、包装)
- 印刷质量检验 (制药、其它)
- 包装质量检验 (食品和饮料)
- 检验部件的存在 / 缺失情况 (电子产品)
- 部件定位 (自动化设备、机器制造商)
- 部件识别 (汽车、电子产品、包装)

Visionscape 和 Intellifind

集成式 Visionscape 软件能提供强大的图像变化处理及分析功能，包括用来检验字符 (OCR 和 OCV) 的高级工具，还能读取和验证各类条码。可选的 Intellifind 工具则是目标查找和模式识别的强大工具。

Visionscape 智能相机：概要

- 每分钟能处理多达 3600 个部件
- 与 Visionscape 软件兼容
- 高度灵活的 C-Mount 接口光学设备
- 直接连接照明选项

HE 1610TIS: VGA 分辨率，含 Intellifind

HE 1610TS: VGA 分辨率，不含 Intellifind

HE 1610TIH: XGA 分辨率，含 Intellifind

HE 1610TH: XGA 分辨率，不含 Intellifind

有关本产品的详情，请浏览网站：www.microscan.com。



形状检验



模式比较



目标查找

Visionscape 智能相机：功能

线形码

- 图像处理
- 图像分析与特征抽取

二维码

- 探伤检验
- 目标定位

OCR/OCV ABC123

- 尺寸测量
- 自定义处理选项

VISIONSCOPE® SMART CAMERA SPECIFICATIONS AND OPTIONS

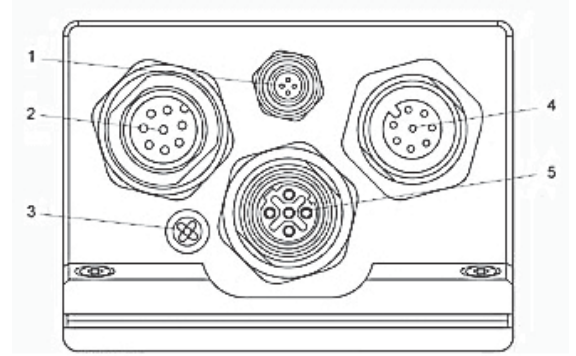
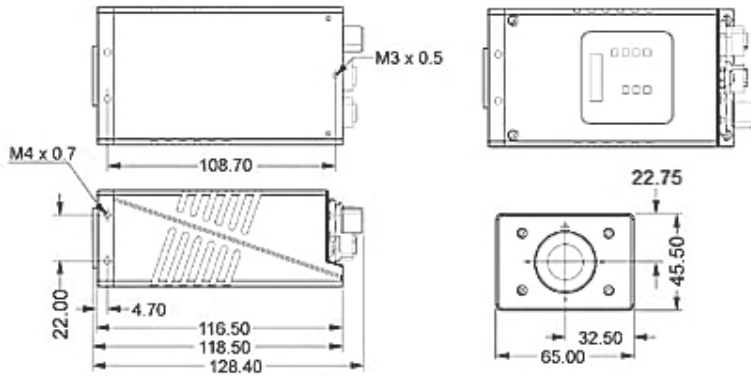

MECHANICAL

Height: 2" (50.8 mm)
Width: 2.25" (57.15 mm)
Depth: 3.89" (98.73 mm)
Weight: 1.70 lbs (0.77 Kg)

LIGHT COLLECTION

Progressive scan, full frame and partial frame
Sensor: 1/3 inch CCD
HE1600TTXS: VGA (640 by 480 pixels)
HE1600TTXH: XGA (1024 by 768 pixels)

COMMUNICATION PROTOCOLS

Interfaces: Ethernet 10/100 MB, supports TCP/IP, DHCP, APIPA and static IP address
Software Flow Control: RS-232

IMAGING RATES

HE1600TTXS: 60 full frame images/second
HE1600TTXH: 30 full frame images/second

ELECTRICAL

Power: 24V at 300 mA (7 W)
Supply Voltage: 20.4 to 28.8 V

INPUTS/OUTPUTS

Trigger input:
Outputs 1-3: 50 mA
Universal I/O 1-4: (Optoisolated) 20 mA at 24 VDC

ENVIRONMENTAL

Operating Temperature: 0° to 50°C (32° to 122°F)
Storage Temperature: -10° to 70°C (-14° to 158°F)
Storage: Up to 95% (non-condensing)

SYMBOLGY TYPES

2D Symbologies: Data Matrix, PDF417, QR Code
Linear Barcodes: Code 39, Code 93, Code 128, UPC/EAN, UPC-E, UPC Supplementals, I2 of 5, BC412, Codabar, Postnet, Pharmacode, GS1 Databar and Composite

INDICATORS

LEDs: Trigger, Fail, Pass, Mode, Power, Link, Activity

INPUTS/OUTPUTS

LEDs: Trigger, Fail, Pass, Mode, Power, Link, Activity

SAFETY CERTIFICATIONS

FCC, CE

ROHS/WEEE COMPLIANT

ISO CERTIFICATION

Issued by Det Norske Veritas
 Cert No. 8446-2007-AQ-USA-ANAB

CONNECTORS

No.	Function
1	Lighting Power and Strobe
2	X1 Power and Primary IO
3	QuicSet
4	Secondary IO and Serial
5	X4 Ethernet

©2009 Microscan Systems, Inc. SP033B-C 05/09
 Performance data is determined using high quality Grade A symbols per ISO/IEC 15415 and ISO/IEC 15416 in a 25°C environment. For application-specific results, testing should be performed with symbols used in the actual application. Microscan Applications Engineering is available to assist with evaluations. Results may vary depending on symbol quality. **Warranty**—One year limited warranty on parts and labor. Extended warranty available.

MICROSCAN®

Microscan Systems, Inc. 公司
 电话: +1 603 598 8400 / 800 468 9503
 传真: +1 603 577 5947
Microscan 亚太有限公司
 电话: +65 6846 1214
 传真: +65 6846 4641
www.microscan.com
产品信息:
 info@microscan.com
自动识别支持:
 helpdesk@microscan.com
视觉支持:
 visionsupport@microscan.com
NERLITE 支持:
 nerlitesupport@microscan.com